

Installation Instructions For Modular Room



Page 1 of 3

1 TOOLS AND EQUIPMENT REQUIRED

See Site Tools and Equipment Items List.

2 HOST ROOM FLOOR

Check that floor is flat and level. If there are any deviations pack out where applicable. Remove any high points. Mark floor for outline position of room. Check with user.

3 UNDERFLOOR INSULATION

The room must be built on damp proof course PVC sheet x 1 layer, which will form a dielectric layer when electrical isolation is needed, or as insulation against damp.

4 PREPARATION PRIOR TO INSTALLATION

Using degreaser, clean all mating surfaces of panels.
Using Medium A/120 grit buffing wheels in an electric drill polish all panel mating surfaces.

5 PANEL ASSEMBLY

- 5.1 Lay 1 layer of PVC on area where room is to be built. This is to be 50mm larger than the size of the room.
- 5.2 Identify panels for floor. These will be on pallet A lift 1
- 5.3 Starting in corner of wall A and wall D, using dumbbell gasket supplied, fix on inside length and inside width of floor tray using M8 bolts provided. Ensure that an extra 100mm of gasket is left long, on both length and width of panel, as diagram "A" below, panel 1.

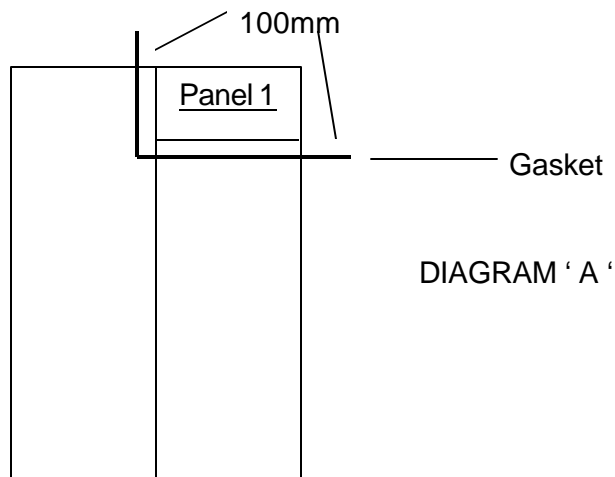

- 5.4 Repeat paragraph 3 above on all floor panels. When all panels are

Issued by	T Crowe	Issue number	2	Date	22 January 1999
-----------	---------	--------------	---	------	-----------------

Installation Instructions For Modular Room



Page 2 of 3

in position, overlap the 100mm flying leads **but ensure the gasket is staggered** as in diagram "B" below.



DIAGRAM ' B '

- 5.5 Check that the base is square, tighten using spanner and ratchet socket set.
- 5.6 Lay out wall panels.
- 5.7 Temporarily fix gasket as paragraph 3, 1 length, 1 width, leaving 100mm flying leads.
- 5.8 Complete one corner then carry on with the walls as diagram "C" below. **Refer to Diagram ' D '**

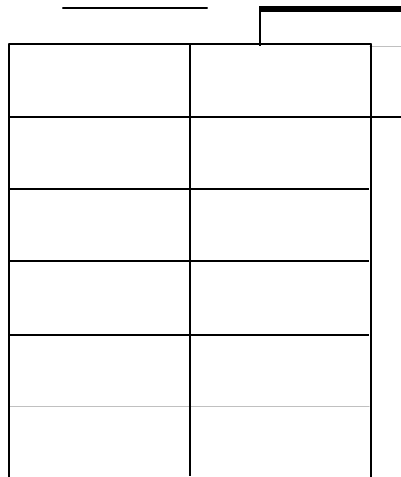

DIAGRAM ' C '

Plan View showing Wall Panels

- 5.9 Complete 3 walls.
- 5.10 Lay out ceiling panels.
- 5.11 Temporarily fix gasket as paragraphs 3 and 8 holding gasket on where possible with double sided tape and M8 bolts.

5.12 Using *Genie Hoist* / panel lifter, position ceiling tray. With tapered punch,

Issued by	T Crowe	Issue number	2	Date	22 January 1999
-----------	---------	--------------	---	------	-----------------

Installation Instructions For Modular Room



Page 3 of 3

pierce gasket and fit nuts and bolts all round. Where structural steelwork is used, position drop-rod ties and secure ceiling into position.

- 5.13 Continue procedure and complete ceiling, tightening all nuts, bolts and drop rods.
- 5.14 Apply gasket to final wall and fit as before.

6 NOTES

- 6.1 Ensure there is at least 1 layer of gasket completely around mating faces.
- 6.2 In places there will be 2, (possibly 3) layers of gasket. This will not present a problem provided they are staggered as shown on diagram 3.
- 6.3 Always check that all fixings are tightened and secure.
- 6.4 When fitting doors, apply gasket exactly as with wall panels.
- 6.5 Diagrams "D" is typical example of gasketing at corner of floor to wall and wall to ceiling.

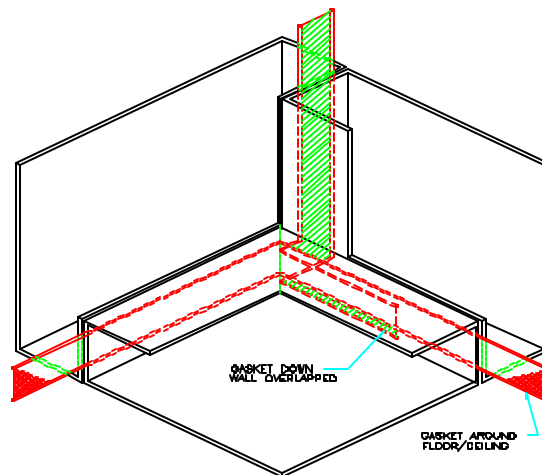

DIAGRAM ' D '

TYPICAL DETAIL OF GASKET
AT CORNER